

SonoFlex 2200 Flexural Disc Transducer



Typical Uses: Low Frequency Sound Source, Calibration Standard, Sound Navigation and Ranging Applications

FEATURES

The SonoFlex 2200 transducer is a flexural disc transducer providing a high power low frequency sound source. Compared to many low frequency projectors the SonoFlex 2200 is compact and low cost.

Due to the flexural motion this transducer makes use of the projector should be operated at depths of 10m or greater to ensure a sufficient amount of pressure is placed on the transducer.

The SonoFlex series are reliable, robust, high performance, low frequency transducers.

ADVANTAGES

- Horizontally omni-directional
- High Performance
- Low Frequency Acoustic Source
- Lightweight with high efficiency

ORDER NUMBER

CTG 2132-001

Please specify any additional cable, alternative connectors and/or calibration requirements with order

TECHNICAL SPECIFICATION

Nominal resonant frequency	2200 Hz (in bending motion)
Integral Amplifier or Tuning Element	No
Receive Sensitivity @ 2180 Hz	-165 dB re 1V/ μ Pa
Recommended receive frequency range	10Hz – 6kHz
Linear frequency range	N/a
Maximum acoustic input @ 2180 Hz	+ 222.5 dB re 1 μ Pa
Transmit sensitivity @ 2100 Hz	+ 131 dB re 1 μ Pa/V at 1m
-3dB bandwidth	300 Hz
Quality Factor	7.3
Recommended transmit frequency range	1.8kHz – 6kHz
Maximum source level @ 2100 Hz	+ 188.5 dB re 1 μ Pa at 1m
Maximum applied voltage	750 Vrms
Horizontal beam pattern	Omni-directional
Vertical beam pattern	Hemispherical

MECHANICAL SPECIFICATION

Dimensions	Maximum outer diameter 132mm, Length 56mm
Transducer head weight in air	***
Transducer head weight in water	**
Minimum operating depth	10m
Maximum recommended operating depth	100m
Survival depth	200m
Operating temperature range	-5 to +35°C
Cable	5m screened twisted pair cable
Connector	Bare ends
Mounting	Dunking

MECHANICAL DRAWING

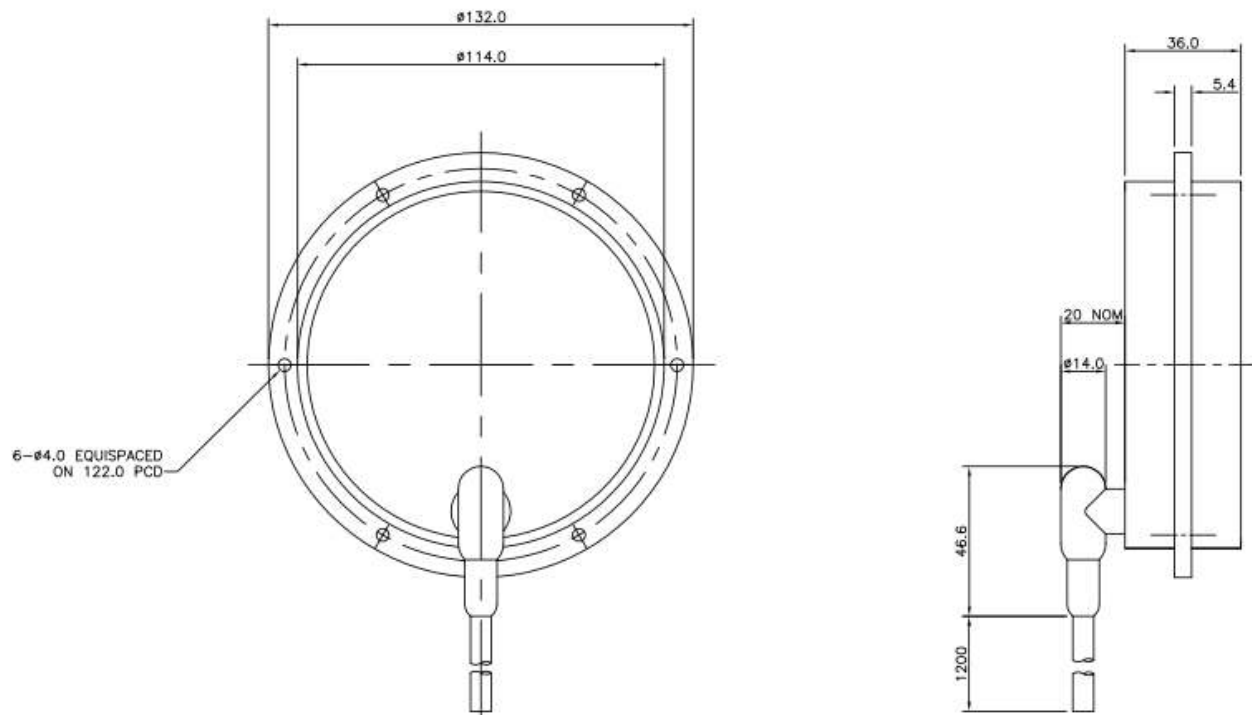

CONNECTOR LAYOUT

Not Applicable

SENSITIVITY

SonoFlex 2200 Sensitivity at 12m depth

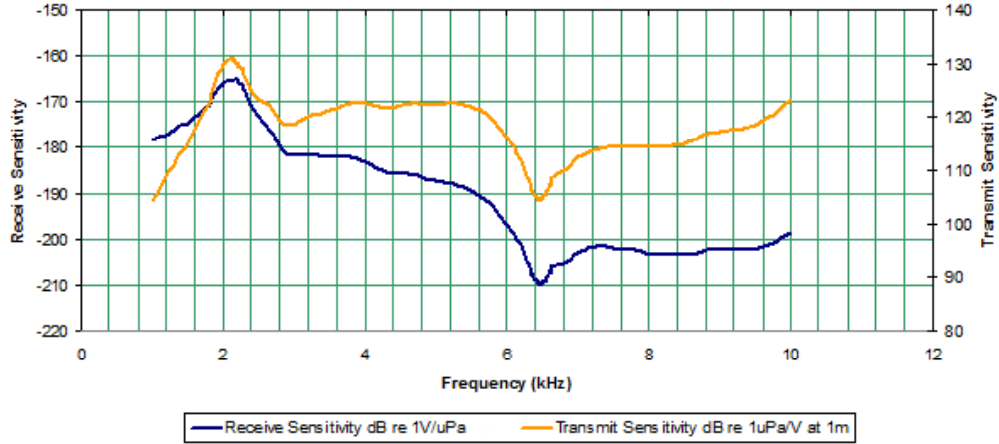

IMPEDANCE

SonoFlex 2200 Impedance at 12m Depth

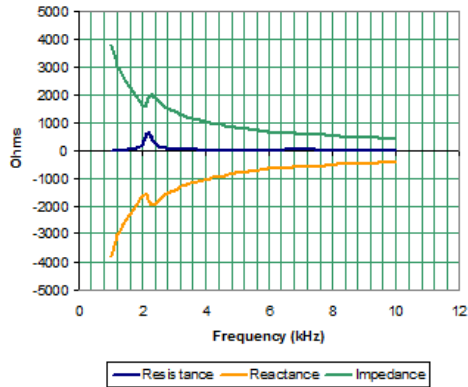

ADMITTANCE

SonoFlex 2200 Admittance at 12m depth

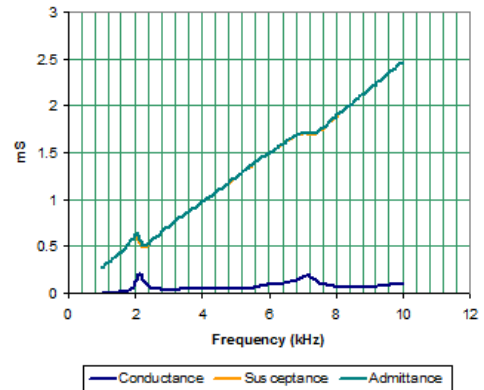

HORIZONTAL BEAM PATTERN

VERTICAL BEAM PATTERN

VARIATIONS

N/a



*** For further information please contact CTG

In view of our policy of continual improvement, the designs and specifications of our products may vary from those described 2271-028-RS-A)

Chelsea
Technologies
Group Ltd

55 Central Avenue
West Molesey
Surrey KT8 2QZ
United Kingdom
Tel: +44 (0)20 8481 9000
Fax: +44 (0)20 8941 9319
sales@chelsea.co.uk
www.chelsea.co.uk